

16g ASTM A653 SS Grade 33 Class 1 G60  
Bare Metal Thickness:  $t = 0.0538"$

Clip A

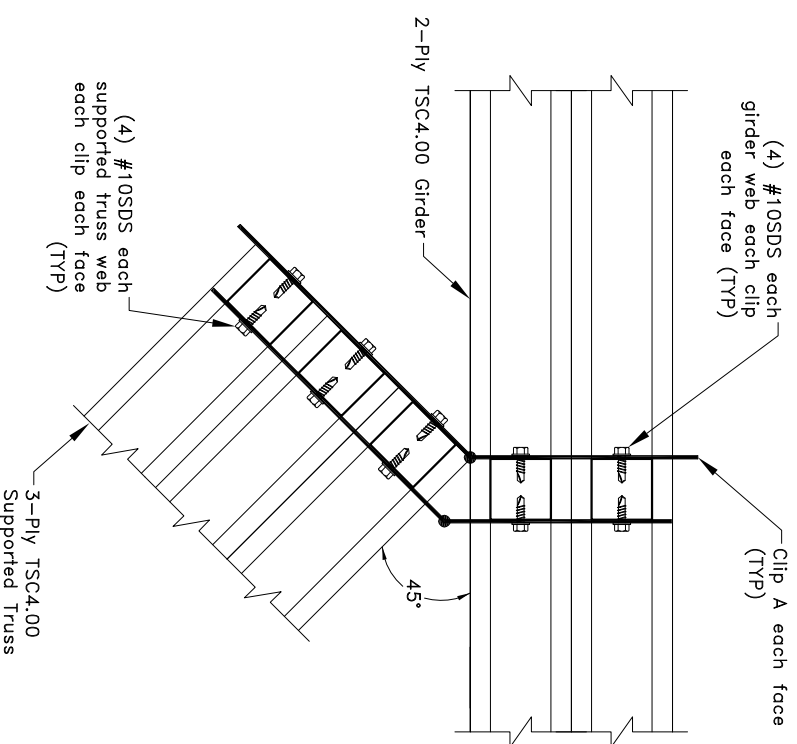

### Plan View

#### General Notes:

1. SDS = Self-Drilling Tapping Screw
2. All edge distances, end distances and spacing are 9/16" minimum.
3. Two clips must be used for one clip pair. Two clip pairs are required for connection as shown. Supported truss must be analyzed with clip type bearings.
4. For clips connecting to a Z-Web vertical refer to TS068 for connection area.
5.  $R_v$  refers to vertical reaction, and  $U$  refers to uplift.
6.  $\bullet$  = Clip Bend; Bend clip only once.
7. Cold-Formed Steel calculations are per the 2010 supplement to the AISI 2007 "North American Specification for the Design of Cold-Formed Steel Structural Members" (S100-07/S2-10).

$$R_v = R_{v1} + R_{v2}$$

$$U = U_1 + U_2$$

$$R_v = U = 3300 \text{ lbs}$$

3-Ply TSC4.00  
Supported Truss

2-Ply TSC4.00 Girder

$R_{v1}$

$U_1$

Clip A each face  
(TYP)

(4) #10SDS each  
supported truss web  
each clip each face  
(TYP)

$R_{v2}$

$U_2$

**TrusSteel**<sup>®</sup>

An ITW Company

[www.TrusSteel.com](http://www.TrusSteel.com)

Florida: 1950 Marley Drive / Haines City, FL 33844 / (800) 755-6001  
Missouri: 13389 Lakefront Drive / Earth City, MO 63045 / (800) 325-4102  
California: 8351 Rovana Circle / Sacramento, CA 95828 / (800) 877-3678

## 45° Truss to Truss Connection for 3-Ply Supported Truss to 2-Ply Girder

ITW Building Components Group, Inc. shall not be responsible for any performance failure in a connection due to a deviation from this detail. Any variation from this detail shall be approved in advance by ITW Building Components Group, Inc.

#### Custom Detail:

TS-CD-TT-4507-002

Date:

10/01/10

#### Custom Detail Category:

Truss-to-Truss Connection