

$$R_v = U = 8750\#$$

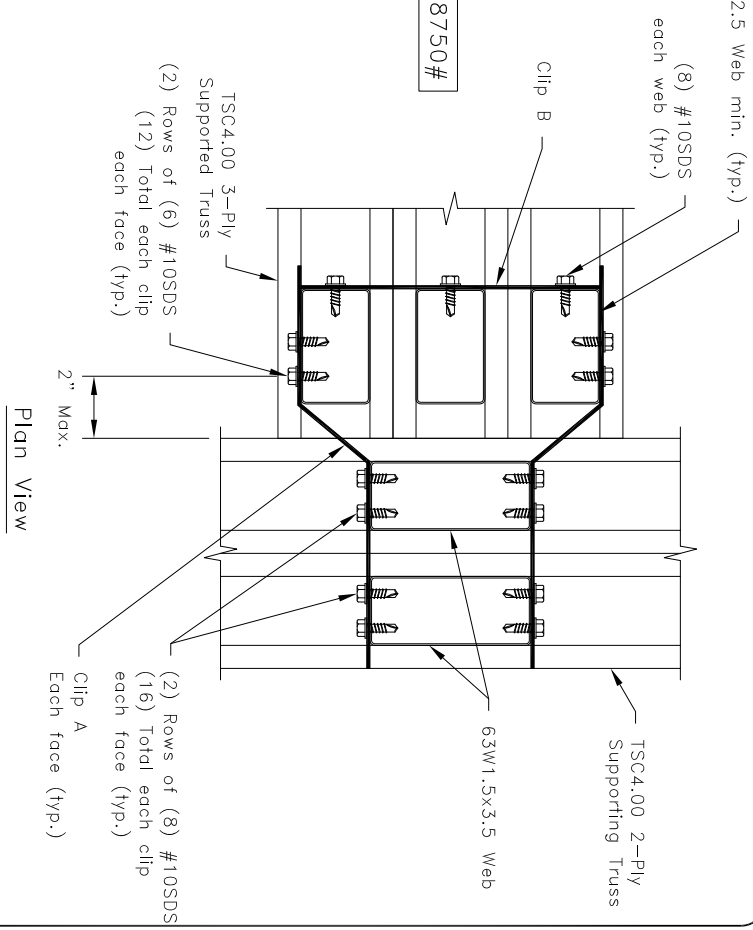

General Notes:

1. SDS = self-drilling tapping screw
2. All edge distances, end distances, and spacing are 9/16" minimum.
3. R_v refers to vertical reaction, and U refers to uplift.
4. Clip fastener placement is identical on opposite side to what is shown.
5. Cold-Formed Steel calculations are per the 2010 supplement to the AISI 2007 "North American Specification for the Design of Cold-Formed Steel Structural Members" (S100-07/S2-10).

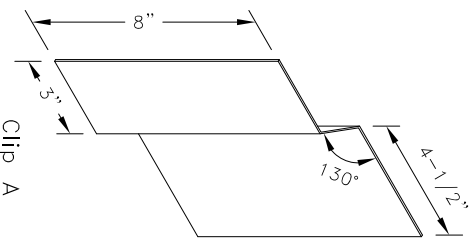

Clip A

10g ASTM A653 SS Grade 33 Class 1 G60
Minimum bare metal thickness: $t = 0.13"$

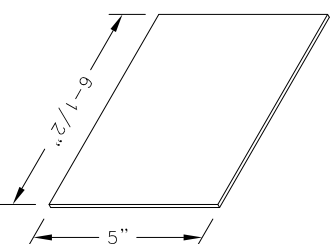

Clip B

14g ASTM A653 SS Grade 33 Class 1 G60
Minimum bare metal thickness: $t = 0.0677"$

TrusSteel®
An ITW Company

www.TrusSteel.com

Florida: 1950 Malety Drive / Haines City, FL 33844 / (800) 755-6001
Missouri: 13389 Lakefront Drive / Earth City, MO 63045 / (800) 326-4102
California: 8351 Rovana Circle / Sacramento, CA 95828 / (800) 877-3678

3-Ply Truss to 2-Ply Girder Connection

ITW Building Components Group, Inc. shall not be responsible for any performance failure in a connection due to a deviation from this detail. Any variation from this detail shall be approved in advance by ITW Building Components Group, Inc.

Custom Detail:

CD120207

Date:

02/17/12

Custom Detail Category:

Truss-to-Truss Connection