

Clip A

14g ASTM A653 Grade 33 G60  
Bare Metal Thickness:  $t = 0.0677"$

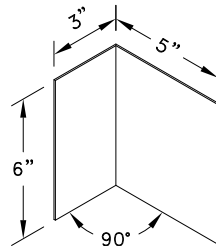

Clip B

14g ASTM A653 Grade 33 G60  
Bare Metal Thickness:  $t = 0.0677"$

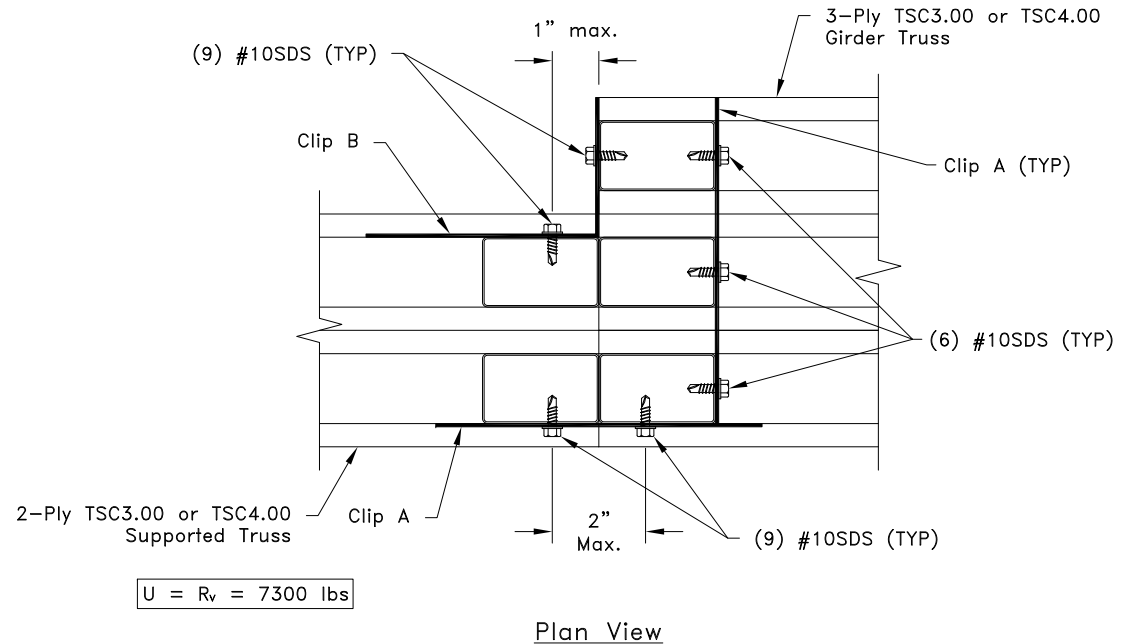

General Notes:

1. SDS = Self-Drilling Tapping Screw
2. Screw end distance and edge distance is  $9/32"$  minimum. Screw spacing is  $9/16"$  minimum.
3. Truss must be analyzed with concentrated loads directly in line with correctly placed girder vertical webs.
4.  $R_v$  refers to vertical reaction and  $U$  refers to uplift.
5. For clips connecting to a Z-web vertical refer to TS068 for connection area.
6. Cold-Formed Steel Calculations are per the 2010 addendum to the AISI 2007 "North American Specifications for the Design of Cold-Formed Steel Structural Members" (S100-07/S2-10).



[www.TrusSteel.com](http://www.TrusSteel.com)

Florida: 2400 Lake Orange Drive, Suite 150 / Orlando, FL 32837 / (800) 755-6001  
Missouri: 13389 Lakefront Drive / Earth City, MO 63045 / (800) 326-4102

## Truss-To-Truss In-Plane Connection

Alpine, a division of ITW Building Components Group, Inc. shall not be responsible for any performance failure in a connection due to a deviation from this detail. Any variation from this detail shall be approved in advance by Alpine, a division of ITW Building Components Group, Inc.

**Custom Detail:**

CD150105

**Date:**

01/15/15

**Custom Detail Category:**

Truss-To-Truss Connection