

$$U_{max} = R_v, U_{max} = 1760 \text{ lbs}$$

Section A-A

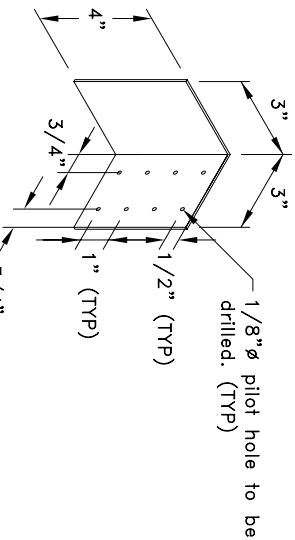
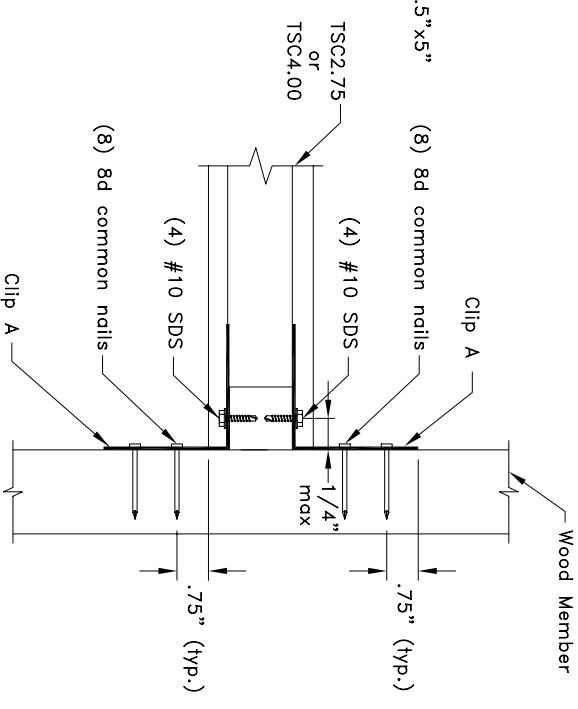

Clip A

16g ASTM A653 SS Grade 33 Class 1 G60

Bare metal thickness: t = 0.0538"

General Notes:

1. SDS = Self-Drilling tapping screw.
2. Supported truss must be designed utilizing a clip bearing type.
3. Connection to resist truss vertical reaction only.
4. Cold-Formed Steel calculations are per the 2004 addendum to the 2001 AISI North American Specification for the Design of Cold-Formed Steel Structural Members.
5. Wood member calculations are per ANSI/AF&PA NDS – 2005 using a duration factor of 1.15.



www.TrusSteel.com

Florida: 1950 Marley Drive / Haines City, FL 33844 / (800) 755-6001  
Missouri: 13389 Lakeloft Drive / Earth City, MO 63045 / (800) 326-4102  
California: 8351 Rovana Circle / Sacramento, CA 95828 / (800) 877-3678

## 90 Degree Truss to Wood Member Support

ITW Building Components Group, Inc. shall not be responsible for any performance failure in a connection due to a deviation from this detail. Any variation from this detail shall be approved in advance by ITW Building Components Group, Inc.

**Standard Detail:**

TS-CP-TB-04-004

**Date:**

03/31/08

**Custom Detail:**

Truss-To-Support