

Side View

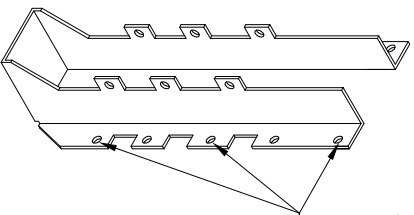

Fill these holes with
Simpson Titen screws
each side

$R_v = 1500 \text{ lbs}$
$U = 750 \text{ lbs}$

Simpson HU212

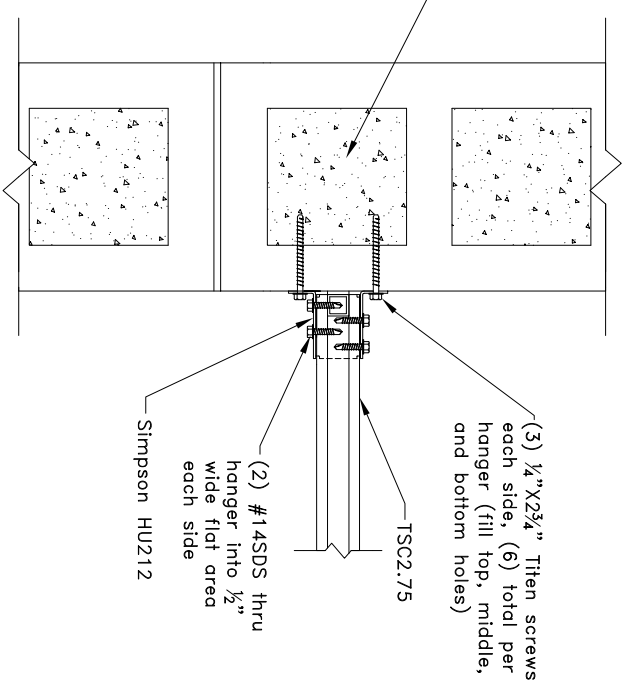

Plan View

General Notes:

1. SDS = Self-Drilling Tapping Screw
2. #14SDS screw spacing, end distance and edge distance is $\frac{3}{4}$ " minimum.
3. Simpson Titen screw spacing is 3", end and edge distance is 1 $\frac{1}{2}$ ".
4. Simpson Titen screws are not to be installed until the grout has reached the specified design strength. Refer to manufacturer's publications regarding proper installation of Simpson Titen screws.
5. Simpson Titen screw capacity is based on Simpson catalog C-2009
6. Grout shall have a $f'_c = 2000 \text{ psi}$ or greater.
7. It is the responsibility of the building designer to verify that the structural support members are designed for all applicable loads including (but not limited to) the loads given on this detail.
8. Cold-Formed Steel Calculations are per the 2004 addendum to the "AISI 2001 North American Specification for the Design of Cold-Formed Steel Structural Members."

TrusSteel®
An ITW Company

www.TrusSteel.com

Florida: 1950 Marley Drive / Haines City, FL 33844 / (800) 755-6001
Missouri: 13389 Lakefront Drive / Earth City, MO 63045 / (800) 326-4102
California: 8351 Rovana Circle / Sacramento, CA 95828 / (800) 877-3678

**90° Truss to CMU Wall
Connection for
Vertical Reaction**

ITW Building Components Group, Inc. shall not be responsible for any performance failure in a connection due to a deviation from this detail. Any variation from this detail shall be approved in advance by ITW Building Components Group, Inc.

Custom Detail:
TS-CD-TB-C4-002

Date:
10/13/09

Custom Detail:
Truss to Bearing